

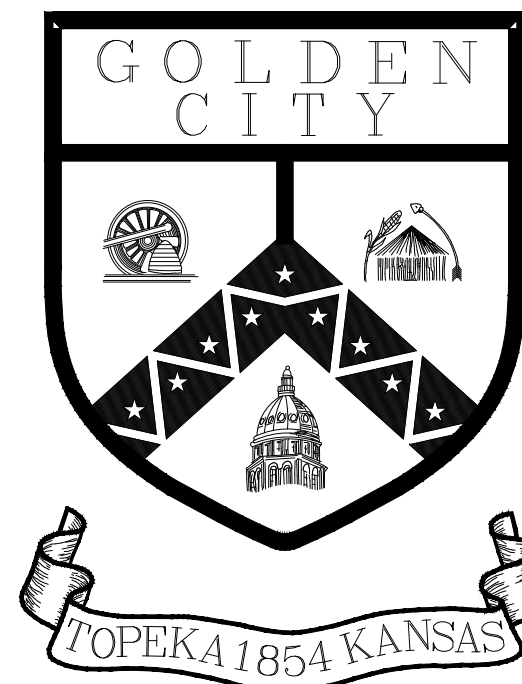

STREET IMPROVEMENT PROJECT 841098.01 STORM SEWER IMPROVEMENT PROJECT 501125.01 WATER SERVICE LINE IMPROVEMENT PROJECT 281300.13

Southwest Moundview Drive Southwest 21st Street to Southwest 19th Street



INDEX TO SHEETS

SHEET NO.	TITLE
1	TITLE SHEET
2	GENERAL NOTES
3	SUMMARY OF QUANTITIES
4	TYPICAL SECTIONS
5	REMOVAL OF EXISTING STRUCTURES
6-8	PLAN AND PROFILE
9	DRIVEWAY PLAN
10-17	CITY STANDARDS
18-19	STORM SEWER PLAN AND PROFILE
20-21	CONSTRUCTION SEQUENCING
22-23	TEMPORARY TRAFFIC CONTROL PLAN
24-26	TRAFFIC CONTROL DETAILS
27-35	CROSS SECTIONS

Know what's below. Call 811 before you dig or visit us at www.kansasonecall.com

"Kansas One-Call" is the Underground Utility Notification center for the State of Kansas. Through this facility, you can notify operators of underground facilities of proposed excavations to request that the underground facilities be marked before you dig.

Kansas Statute annotated #66-1801 through #66-1815 requires anyone who engages in any type of excavation to provide advance notice of at least two full working days, but not more than 15 calendar days, excluding weekends and holidays.

The person who is doing the work is responsible for calling Kansas One-Call. If the owner contracts with a professional excavator to do the excavation, then the professional excavator is responsible for calling Kansas One-Call.

The service provided by Kansas One-Call to excavators is free of charge.

Call 785-368-3111 for emergencies with City of Topeka utilities.

UTILITY OWNER CONTACTS

Cable TV

Cox Communications
931 SW Henderson Rd.
Topeka, KS 66615
Dean Cape
(785)320-0308(cell)
dean.cape2@cox.com

Electric

Evergy
PO Box 889
4001 NW 14th St.
Topeka, KS 66603
Jenny Rohr
(785)580-2123
jennifer.rohr@evergy.com

Fiber Optic - City of Topeka

City of Topeka, Info. Tech.
620 SE Madison St., 3rd Floor
Topeka, KS 66603
Wesley L. White
(785)338-2633
wlwhite@topeka.org

Fiber Optic - LUMEN

LUMEN
711 E. 19th St.
Kansas City, MO 64108
Rick Redel (816)518-2804
richard.redel@lumen.com
Relocations: relocations@lumen.com

Fiber Optic - USD 501

USD 501, Info. Tech.
1900 SW Hope St.
Topeka, KS 66604
Joergen Laigaard
(785)438-4750
jlaigaard@tps501.org

Fiber Optic - KsFiberNet

Kansas Fiber Network LLC
10875 Benson, Suite 250
Overland Park, KS 66210
Brad Burger
(913)213-2937
bburger@ksfiber.net

Gas

Kansas Gas Service
PO Box 3538
200 E 1st St.
Topeka, KS 66601
Anna Frizell
(785)431-4251
(785)438-7017 (cell)
anna.frizell@onegas.com
For Gas Leaks 1-888-482-4950
911 must also be called immediately

Telephone

AT&T Corp.
220 SE 6th St., Rm 236
Topeka, KS 66603
Ezra Brown
(785)596-9905
eb409q@att.com

Traffic Signal

City of Topeka, Traffic Ops.
927 NW Harrison St.
Topeka, KS 66612
Duane Morris
(785)368-3913
cmorris@topeka.org

Fiber Optic - AT&T Transmission

AT&T Services, Inc.
1425 Oak Street
Kansas City, MO 64016
Lenny Vohs
(770)335-8244
lv2121@att.com

Fiber Optic - Giant Communications

Giant Communications
515 S Kansas Ave. Suite 210
Topeka, KS 66603
Lance Lyman
(785)362-3312
lancelyman@giantcomm.net

Telephone/Fiber Optics

Verizon/MCI
Jeffrey Wiard
(620)242-6647
Jeffrey.Wiard@verizonwireless.com

Sanitary/Storm Sewer

City of Topeka, WPC Div.
1115 NE Poplar St.
Topeka, KS 66616
Darrin A. Coffland
(785)368-2467
dcoffland@topeka.org

Water

City of Topeka, Water Dist.
3245 NW Waterworks Dr.
Topeka, KS 66606
Duncan Theuri
(785)368-0152
dtheuri@topeka.org

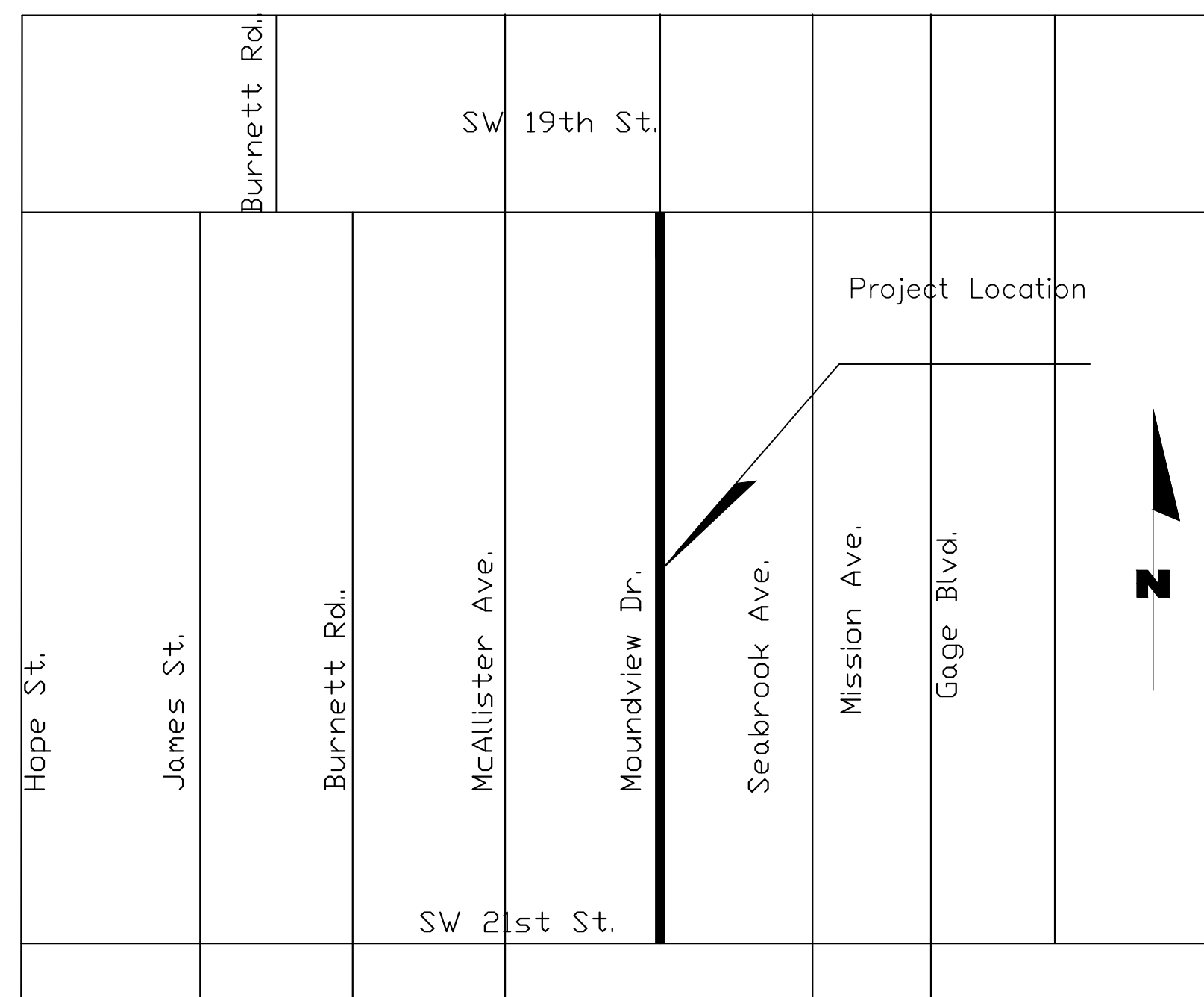

LOCATION MAP

LEGEND

Overhead Telephone Line	----	DHT	-----	Section Corner	-----	△
Underground Telephone Line	----	UT	-----	Control Point	-----	◆
Overhead Cable	-----	DHCTV	-----	Property Pin	-----	•
Underground Cable	-----	UCTV	-----	Power Pole	-----	■
Overhead Electric Line	-----	DHE	-----	Telephone Pole	-----	⊕
Underground Electric Line	-----	UE	-----	Street Light	-----	⊙
Water Line	-----		-----	Guy Pole	-----	□
Gas Line	-----		-----	Guy Wire	-----	→
Sanitary Sewer	-----	SS	-----	Fire Hydrant	-----	⊕
Storm Sewer	-----	STM	-----	Water Meter	-----	⊕
Fiber Optic Line	-----	FO	-----	Water Valve	-----	⊕
Centerline	-----		-----	Gas Meter	-----	⊕
Right-of-Way Line	-----		-----	Gas Valve	-----	⊕
Property Line	-----		-----	Mail Box	-----	⊕
Lot Line	-----		-----	Existing Storm Inlet	-----	⊕
Chain link Fence	-----		-----	Existing Manhole	-----	⊕
Wood Fence	-----		-----	Existing Traffic Manhole	-----	⊕
Wire Fence	-----	X	-----	Sign	-----	⊕
RailRoad Tracks	-----		-----	Tree	-----	⊕
				Stump	-----	⊕
				Shrub	-----	⊕



Feb 25, 2026

CITY OF TOPEKA, KANSAS	
DEPARTMENT OF PUBLIC WORKS - ENGINEERING DIVISION	
RELEASED FOR CONSTRUCTION	
_____	_____
CITY ENGINEER	DATE
ATTEST:	
_____	_____
CITY CLERK	DATE
REVIEWED BY	
_____	_____
UTILITIES	DATE

GENERAL NOTE:

All construction methods and materials used in the construction of the improvements covered by these plans shall be in accordance with the Standard Technical Specifications and current revisions on file in the Office of the City Engineer, City of Topeka, Kansas

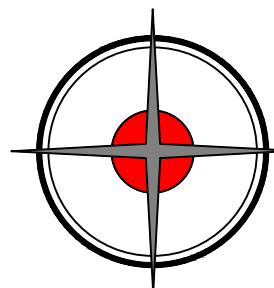

DRIGGS DESIGN GROUP, PA

Surveying Engineering Planning

MANHATTAN - HAYS - EMPORIA - TOPEKA - GOODLAND

TITLE SHEET LOCATION MAP

DATE: 9/5/2025

SHEET: 1 of 35

PROJ.: 841098.08
501125.01

**MOUNDVIEW DRIVE STREET IMPROVEMENTS - 21ST STREET TO 19TH STREET
PROJECT NO. T-841098.08 SUMMARY OF QUANTITIES**

BASE BID ROAD QUANTITIES - CITY OF TOPEKA

ITEM NO.	DESCRIPTION	QUANTITY	UNIT
1	MOBILIZATION	1	LS
2	CONTRACTOR CONSTRUCTION STAKING	1	LS
3	REMOVAL OF LARGE TREE	3	EA
4	TRAFFIC CONTROL	1	LS
5	PAVEMENT REMOVAL	2673	SY
6	AGGREGATE BASE - AB-3 (6")	2673	SY
7	6" CONCRETE DRIVEWAY	1302	SF
8	COMBINED CURB AND GUTTER TYPE 2	2100	LF
9	INLET PROTECTION (CURB)	7	EA
10	SEEDING, FERTILIZING, AND MULCHING	0.5	ACRES

**MOUNDVIEW DRIVE STREET IMPROVEMENTS - 21ST STREET TO 19TH STREET
PROJECT NO. T-841098.08 SUMMARY OF QUANTITIES**

ALTERNATE #2 - CITY OF TOPEKA

ITEM NO.	DESCRIPTION	QUANTITY	UNIT
22	UNCLASSIFIED EXCAVATION	1020	CY
23	8" ASPHALTIC CONCRETE PAVEMENT	2673	SY

**MOUNDVIEW DRIVE STREET IMPROVEMENTS - 21ST STREET TO 19TH STREET
PROJECT NO. T-841098.08 SUMMARY OF QUANTITIES**

ALTERNATE #3 - CITY OF TOPEKA

ITEM NO.	DESCRIPTION	QUANTITY	UNIT
24	COLD MILLING (2")	391	SY
25	2" ASPHALTIC CONCRETE OVERLAY	391	SY

**MOUNDVIEW DRIVE STORM SEWER IMPROVEMENTS - 21ST STREET TO 19TH
STREET PROJECT NO. T-501125.01 SUMMARY OF QUANTITIES**

BASE BID STORM SEWER QUANTITIES - CITY OF TOPEKA

ITEM NO.	DESCRIPTION	QUANTITY	UNIT
11	REMOVAL OF EXISTING STRUCTURES	1	LS
12	FLOWABLE FILL*	66	CY
13	TYPE I-P CURB INLET (6'X4')	2	EA
14	TYPE I-P CURB INLET TOP (6'X4')	2	EA
15	CONNECTION TO EXISTING STRUCTURES	3	EA
16	15" STORM SEWER (RCP), CLASS 2	56	LF
17	18" STORM SEWER (PPP)	453	LF
18	6" CONCRETE DRIVEWAY	897	SF
19	CRUSHED ROCK SURFACING	4.5	TON

*See General Note 11. Flowable Fill quantity is for information only.

**MOUNDVIEW DRIVE WATER SERVICE LINE IMPROVEMENTS - 21ST STREET TO
19TH STREET PROJECT NO. T-281300.13 SUMMARY OF QUANTITIES**

BASE BID WATER SERVICE LINES - CITY OF TOPEKA

ITEM NO.	DESCRIPTION	QUANTITY	UNIT
26	1" SERVICE LINE	276	LF
27	INSTALL 5/8" METER, METER BOX/PIT AND TOP (OWNER FURNISHED)*	6	EA

**MOUNDVIEW DRIVE STREET IMPROVEMENTS - 21ST STREET TO 19TH STREET
PROJECT NO. T-841098.08 SUMMARY OF QUANTITIES**

ALTERNATE #1 - CITY OF TOPEKA

ITEM NO.	DESCRIPTION	QUANTITY	UNIT
20	UNCLASSIFIED EXCAVATION	800	CY
21	6" REINFORCED CONCRETE PAVEMENT	2673	SY

Water Service Schedule

**MOUNDVIEW DRIVE WATER SERVICE LINE IMPROVEMENTS- 21ST STREET TO 19TH
STREET PROJECT NO. T-281300.13 SUMMARY OF QUANTITIES**

Address	Meter Size	Service Line Size at Point of Connection	Service Line Material at Point of Connection	New Meter Pit Lid Elevation	Main Size	Remarks
2008 SW Moundview Dr	5/8"	3/4"	Copper	966.72	4"	
2012 SW Moundview Dr	5/8"	3/4"	Copper	966.50	4"	
2018 SW Moundview Dr	5/8"	3/4"	Copper	966.16'	4"	
2022 SW Moundview Dr	5/8"	3/4"	Copper	965.88'	4"	
2026 SW Moundview Dr	5/8"	3/4"	Copper	964.62'	4"	
2030 SW Moundview Dr	5/8"	3/4"	Copper	963.40'	4"	

02-25-2026 Revised Plans to include water service lines

NO.	DATE:	REVISION	BY:	APP'D

DRAWN BY: E.CHAVEZ
 APP'D BY: E.NICHOL
 FIELD BOOK: ---
 SURVEYED BY: A.WOLFE
 PLOTTED: 2/25/2026

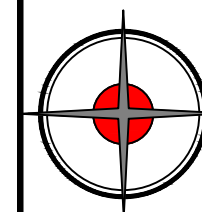

DRIGGS DESIGN GROUP, PA
 Surveying Engineering Planning
 MANHATTAN - HAYS - EMPORIA - TOPEKA - GOODLAND



**MOUNDVIEW DRIVE STREET IMPROVEMENTS
841098.08
MOUNDVIEW STORM SEWER IMPROVEMENTS
501125.01
FROM SW 21ST TO SW 19TH**

SUMMARY OF QUANTITIES

DATE: 2/25/2026
 SHEET: 3 of 35
 PROJ.: 841098.08
501125.01